

# **GALASSI&ORTOLANI**

**VALVESMANUFACTUREDIVISION**



PINCHVALVES  
BUTTERFLYVALVES  
DIAPHRAGMVALVES  
CHECKVALVES  
BALLVALVES  
GATEVALVES  
**THERMOPLASTICVALVES**

**The answer to problems of:  
corrosion, abrasion, clogging, contamination.**

## **G&O THERMOPLASTIC VALVES**

Galassi & Ortolani has permanently resolved the problems for piping system of steel industries, Chloralkali projects and many other chemical plants with introduction of right material of construction for their most aggressive and corrosive applications.

### **PRODUCT FEATURES:**

**Diaphragm valves:** Weir type, conveyed flow – Flanged Ends, NPT Ends & SW / BW Ends

Flanged Valves sized from ½" through 6"; NPT / SW / BW Ends sized from ½" through 3"

Manual, Pneumatic and Electric actuated.

**Butterfly Valves:** To mount between flanges ANSI/BS/DIN/JIS

Sized from 2" through 24"

Manual, Pneumatic and Electric actuated.

**Ball valves:** To mount between flanges ANSI/BS/DIN/JIS

Sized from ½" through 6"

Manual, Pneumatic and Electric actuated.

**Check valves:** To mount between flanges ANSI/BS/DIN/JIS

Sized from 1" through 8"

### **PERFORMANCE FEATURES:**

- Quick and easy replacement of the trim
- No maintenance
- Long durability

### **BODY VALVE MATERIALS:**

- Diaphragm Valves: PP/ISO.PP/PPH/PVDF
- Butterfly Valves: PP/ISO. PP /PVDF/UPVC/CPVC
- Ball valves: PP/ISO.PP/PVDF/ETFE
- Check valves: PP/ISO.PP/PVDF/ETFE

### **Trim Materials:**

- Diaphragm Valves:  
NEOPRENE/EPDM/PTFE+EPDM/PTFE+PVDF+EPDM
- Butterfly Valves: PP/ISO.PP/PVDF/UPVC/CPVC
- Ball valves: PP/ISO. PP/PVDF/ETFE
- Check valves: PP/ISO.PP/PVDF/ETFE



#### DESIGN/DIMENSIONS APPLICABLE STANDARD

- As per manufacturer standard

#### CERTIFICATES AVAILABLE

- EN 10204 3.1.

#### INSPECTION TESTS AVAILABLE BY:

- SGS GLOBAL TRADE SOLUTIONS
- ITS INTERTEK TESTING SERVICES
- BV BUREAU VERITAS

#### MAJOR MARKETS SERVED

- Chlor Alkali plants
- Cold Rolling Mills & Steel Industries
- Chemical and pharmaceutical Industries

#### OPTIONS:

- Limit switches
- Solenoid valve
- Position indicator
- Air filter regulator
- 3:15 PSI positioner
- 4:20mA electro pneumatic positioner or 4:20mA electronic transmitter of position 30°-90° angle
- Mono/Triphase AC motor  
(240V/50Hz through 400V/50Hz)



## MANUAL DIAPHRAGM VALVES

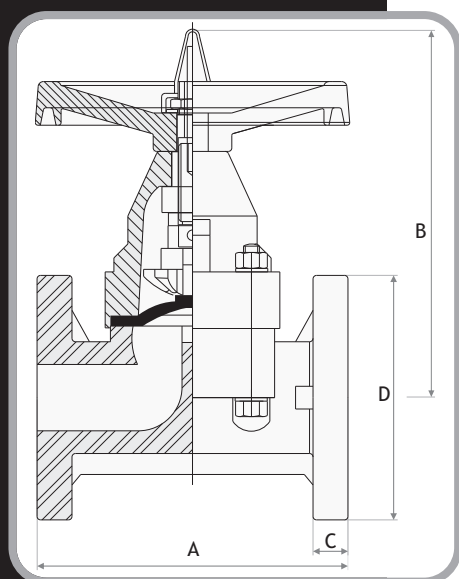

Size mm	A (+/- 3 mm)	B	C	D
15	120	95	17	95
20	150	150	17	120
25	150	150	17	120
40	178	205	18	140
50	213	215	19	160
65	280	285	24	200
80	280	285	24	200

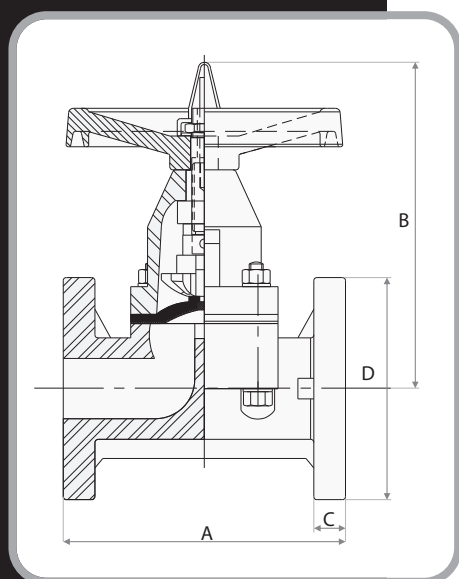

Size mm	A (+/- 3 mm)	B	C	D
100	312	380	23	228
150	408	525	26	280

## MANUAL BUTTERFLY VALVE LEVER TYPE

**GALASSI&ORTOLANI**  
VALVES MANUFACTURE DIVISION

Size mm	A	B	C	D
50	253	160	42	220
65	260	182	42	215
80	286	200	46	220
100	309	229	54	215
125	383	250	66	310
150	430	280	74	310
200	475	338	88	415

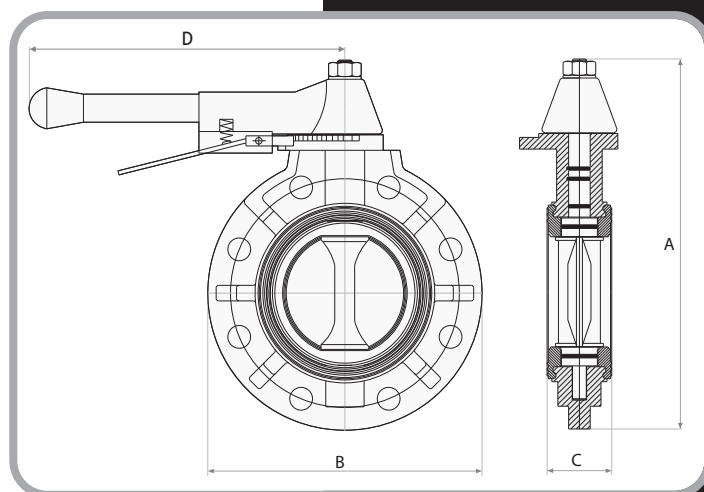

## MANUAL BUTTERFLY VALVE GEAR OPERATED

Size mm	A	B	C	D
150	384	280	74	240
200	441	340	87	240
250	503	400	111	240
300	642	495	126	240
350	665	514	132	244
400	753	594	169	252
450	803	634	181	269
500	878	704	190	330
600	984	805	209	330

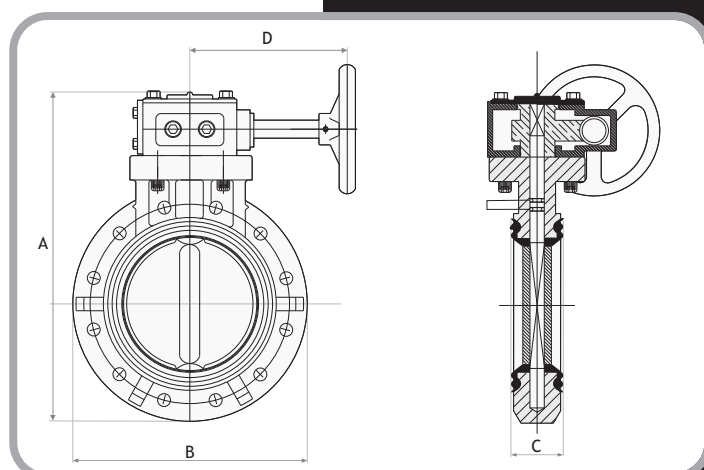

## MANUAL BALL VALVE FLANGED ENDS

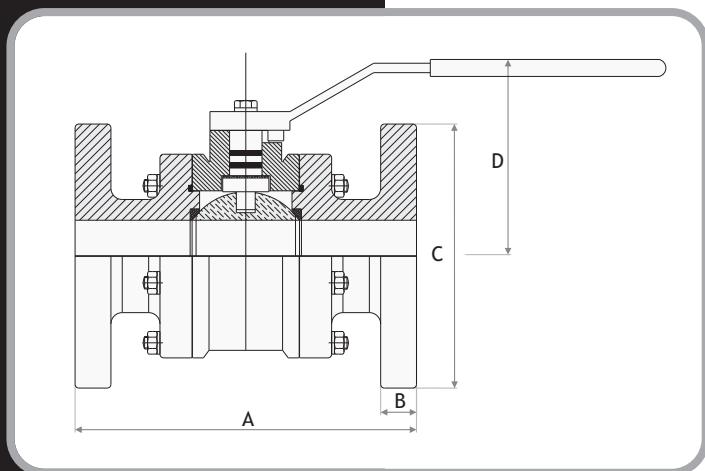

Size mm	A	B	C	D
15	132	17	95	70
20	138	17	114	80
25	158	17	120	100
40	182	17	140	105
50	212	19	165	120
65	238	22	180	133
80	255	23	203	145
100	298	23	230	175
150	415	30	305	253

## MANUAL BALL VALVE THREADED ENDS

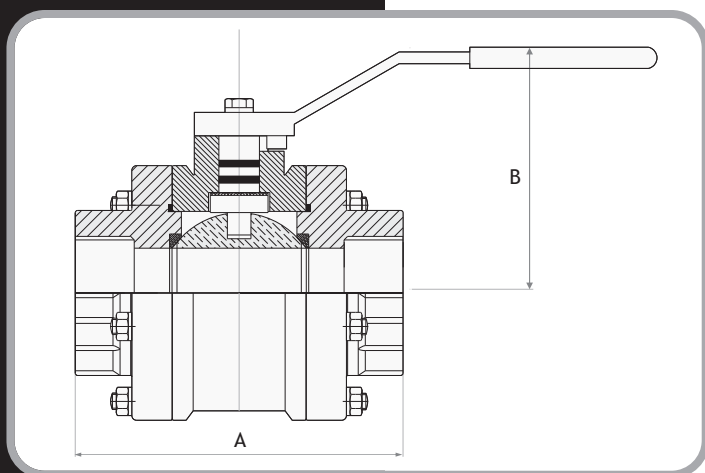

Size mm	A	B
15	105	70
20	110	80
25	135	100
40	132	105
50	160	120

## CHECK VALVES BALL TYPE

Size mm	A (+/- 3 mm)	B	C
25	140	120	17
40	175	140	17
50	212	165	19
65	245	203	23
80	245	203	23
100	300	230	23
150	355	280	29

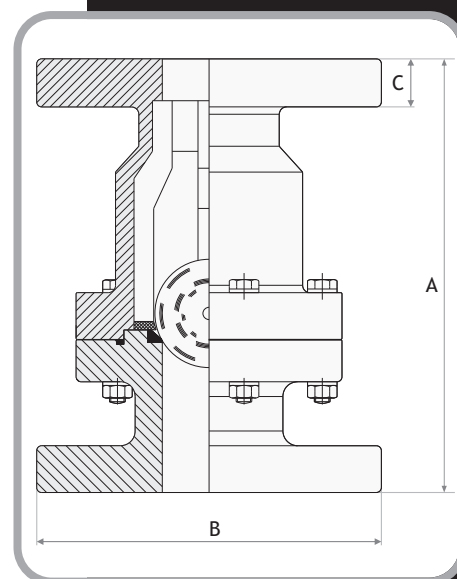

## SWING CHECK VALVES WAFER TYPE

Size mm	A (+/- 3 mm)	B	C
100	168	85	35
150	216	110	40
200	272	144	40

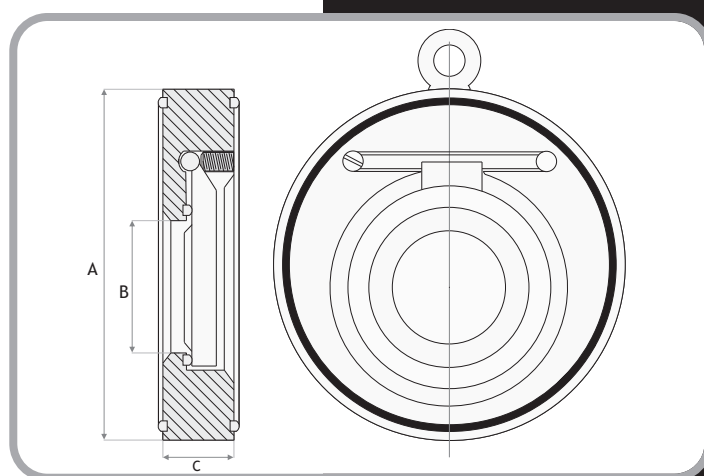

Galassi & Ortolani Spa has been making special valves since 1937.

The range of products, comprising:

- diaphragm valves
- pinch valves
- butterfly valves
- check valves
- pneumatic actuators
- ball valves
- gate valves
- thermoplastic valves

is divided into several versions and variants and is used, in particular, in the chemical industry, in water processing and distribution.

The experience achieved during over 75 years in the making of valves for various-nature fluid-management plants has allowed Galassi & Ortolani to make a name in the plant-construction market as a reference producer both at domestic and international level.

#### ARTISANS OF YEAR 2000

- Uni En ISO 9001 Quality Management System Certified
- Choice of ISO certified suppliers who utilize the latest casting technologies
- Check of all incoming components so as to find and eliminate those defective
- Check of all machined products for conformance to our dimensional standards
- Hydraulic test of body valve at 110/115% of rated pressure to ensure the best tightness
- Each valve being coated with an anti-corrosive varnish at no additional cost

#### CNC PROCESS

Equipment for Machining Centres and CN Lathes

- To have the utmost control possible on each component
- To allow total interchangeability of each component in case it is changed
- To ensure valve perfect stability and connection
- To reduce Torque rating

#### CUSTOMER HELP

- Customer's personalized treatment, both pre-sales and after-sales
- Direct intervention by our experts on Plants upon request
- Extensive store of spare parts for immediate availability



**GALASSI&ORTOLANI**  
VALVESMANUFACTUREDIVISION

GALASSI & ORTOLANI SpA

Via Ghirlandaio, 2/4 - 20096 Pioltello (MI) Italy

Tel. +39 02.92103459 - 02.92103801 - 02.92103802 - Fax +39 02.92103804

E-mail: info@galassiortolani.com - www.galassiortolani.com

CISQ

**IONet**  
THE INTERNATIONAL CERTIFICATION NETWORK

**SINCERT**  
ACCREDITED ORGANISM OF CERTIFICATION & SUPERVISION

ISO 9001:2000  
Registr. n° IT 44453